

# HEAT LINE PLUS - EC/K - EC/C



## Spare parts

MODEL*	REFERENCE
<b>11</b> <b>9</b> Threaded polyamide sensor well 15/21 male	<b>WIB01625</b>
<b>11</b> <b>10</b> Adapter for flow switch	<b>WIB01611</b>
<b>16</b> <b>15</b> <b>14</b> <b>13</b> 2 pieces semi-union Ø 63 + reduction. Ø 50 (HEAT LINE)	<b>W40RDU</b>
<b>19</b> <b>18</b> <b>20</b> Circulating pump 2 m³ 25/40 (EC/C, EC/K, HEAT LINE+) With fitting 26/34 + gasket	<b>W49CC4</b>
<b>22</b> Check valve 26/34	<b>WCL03431</b>
<b>23</b> Noryl flow switch	<b>WSK02015</b>
<b>24</b> Sensor for digital thermostat PTC 100	<b>WCE01311</b>
<b>11</b> <b>25</b> Plug 15/21	<b>WIB01609</b>
<b>29</b> HEAT LINE + hood	<b>WIB02695</b>
<b>30</b> Delayed controller ECP200 complete (HEAT LINE+)	<b>WCE02684</b>
<b>23</b> <b>10</b> <b>42</b> Electric box (HEAT LINE +) with flow switch	<b>W49COFKT</b>
<b>A</b> Delayed controller complete (ECP233) (HEAT LINE in box)	<b>WCE01308</b>
<b>B</b> Thermostat 16/40° with well 15/21M (HEAT LINE unequipped)	<b>W20KD02</b>
<b>C</b> Control thermostat 16/40° C bulb 10 (HEAT LINE equipped)	<b>WEG01404</b>
<b>D</b> Control thermostat 16/40 bulb 6	<b>WEG01405</b>
<b>E</b> Exchanger 20 kW Titanium w/o check valve 26/34	<b>W49CUVE20KT</b>
<b>E</b> Exchanger 40 kW Titanium w/o check valve 26/34	<b>W49CUVE40KT</b>
<b>E</b> Exchanger 70 kW Titanium w/o check valve 26/34	<b>W49CUVE70KT</b>

\* When ordering spare parts, please specify the serial number of the heat exchanger.

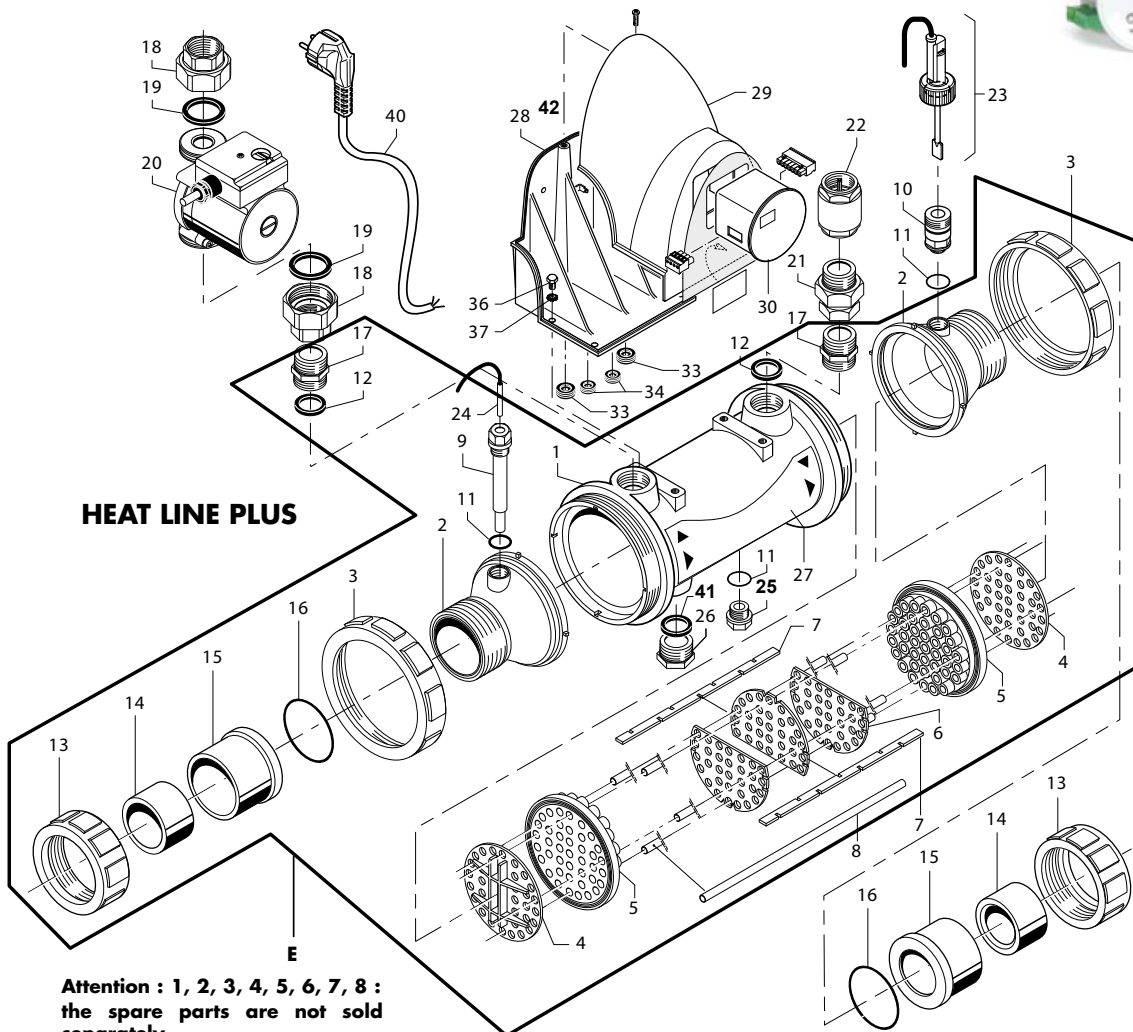

Attention : 1, 2, 3, 4, 5, 6, 7, 8 : the spare parts are not sold separately

